



## Section 1.4

---

### ICON HEALTHCARE ALERT SIGNAGE

Corridor Alert Signs

Patient Room Alert Signs

### PRICE LIST & SPECIFICATIONS

Effective January 1, 2026

All Prices are Suggested List Price

Updated 11.03.25



# ICON Healthcare Alert Signage

## Corridor Alert Signs



C8 shown with Rectilinear Header and EMB



C10



C12

The ICON Corridor Alert sign communicates critical patient information to the doctor, nurse or clinician. Easily lock and unlock the colorful information tabs as needed, using the “push and slide” system concealed behind the hinged panel. Icon tabs are 17/8”w x 17/8”h. Combine additional Infectious Disease Control inserts and room identification in a single system. ICON is ADA compliant and may be customized to meet the requirements of your facility, department or unit. Please submit your requirements.

Model	Description	Size	No Header*	With Header*	Dry Erase Film Upcharge	Est. Ship Weight
<b>8 1/2” wide</b>						
C8	8 Icon Tabs, bottom hinge	8 1/2”w x 12”h	\$540	\$620	\$89	3
C10	10 Icon Tabs, bottom hinge	8 1/2”w x 15”h	\$638	\$717	\$110	4
C12	12 Icon Tabs, bottom hinge	8 1/2”w x 16 1/2”h	\$690	\$770	\$118	5

For Icon Tabs, *see page 48*.

\*Height dimensions include headers. Deduct 2 1/2” for no header models.

### Header Styles - C8, C10 & C12 models only (shown with optional EMB)

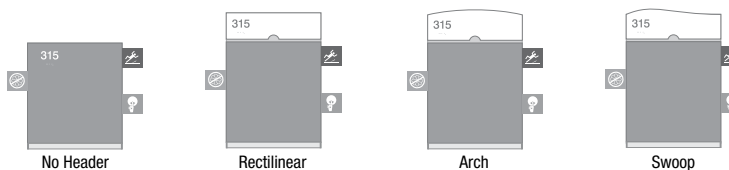

C4S shown with EMB

Model	Description	Size	No Header*	Dry Erase Film Upcharge	Est. Ship Weight
<b>Single-Sided, 6 1/2”w</b>					
C4S	4 Icon Tabs, single-sided, top hinge	6 1/2”w x 9 3/4”h	\$413	\$69	2

For Icon Tabs, *see page 48*.

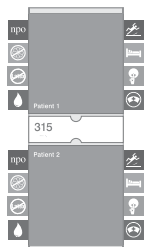

DP16 shown with EMB

Model	Description	Size	With Header*	Dry Erase Film Upcharge	Est. Ship Weight
<b>Dual Occupancy Sign</b>					
DP16	8 Icon Tabs Per Patient - Individual Patient 1 & 2 ID. Top panel hinged at top, bottom panel hinged at bottom.	8 1/2”w x 22”h	\$1,225	\$187	6

For Icon Tabs, *see page 48*.

FOB Pennsylvania

### Specifications & Ordering Information (See pages 49-50)



# ICON Healthcare Alert Signage

## Corridor Alert Signs



**PSTR**  
Staff Education Poster



**C8 with CPH**  
Horizontal placard slides into the front hinged panel frame



**C12 with CPD**  
Vertical placard slides into the front hinged panel frame



**C8 with CPU**  
Placard holder mounts under the hinged panel and the vertical placard slides into place

Model	Description	Size	List	Est. Ship Weight
<b>Options</b>				
EMB	Embossed Room Number, Helvetica ¼"h and Braille on header or hinged panel, ADAAG compliant		\$154	
ICON	Replacement Icon Tabs		\$73	
PSTR	Staff Education Poster, customized with your specific icons. Clear acrylic holder.	22"w x 28"h	\$374	8
	Text instead of Icon image - one-time set up, each		\$131	
	Custom Icon design - one-time set up, each		\$622	
	Logos and customs images		\$84	
	Any PMS Icon or hinged panel color		n/c	

<b>Infectious Disease Control Placard Inserts</b>				
The Infectious Disease Control Placard Inserts along with "Do Not Enter" help to ensure better outcomes for your National Patient Safety goal program for reducing the incidence of healthcare associated infections (HAI's). These inserts are digitally printed on durable, tear and moisture resistant material. Placards insert into a non-glare acrylic holder. Additional inserts can be customized to your needs. Please submit your requirements.				
CPH	Horizontal Placard Insert for hinged panel (Models C8, C10, C12 & DP16)	8 3/8"w x 3 7/8"h	\$209	1
	Set of 4, double-sided, with acrylic holder			
CPH-A	Acrylic holder only, no placards	8 3/8"w x 3 7/8"h	\$80	
CPD	Vertical Placard Insert for hinged panel (Models C10 & C12)	8 3/8"w x 10 ¾"h	\$383	1
	Set of 4, double-sided, with acrylic holder			
CPD-A	Acrylic holder only, no placards	8 3/8"w x 10 ¾"h	\$154	1
CPU	Vertical Placard Insert - mounts under hinged panel (Models C8, C10, C12 & DP16)	8 3/8"w x 10 ¾"h	\$383	1
	Set of 4, double-sided, with acrylic holder			
CPU-A	Acrylic holder only, no placards	8 3/8"w x 10 ¾"h	\$154	

FOB Pennsylvania

**CPH — Set of 4 double-sided placards**

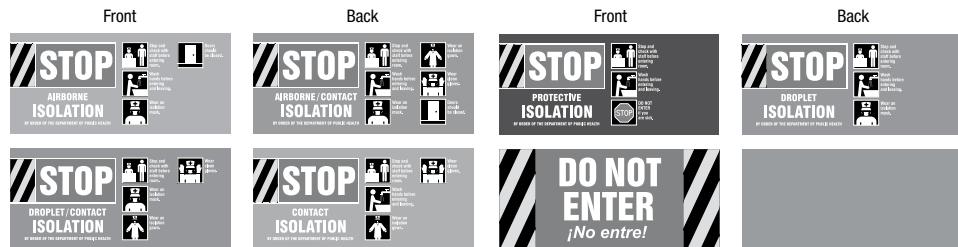

**CPD & CPU**



**Specifications & Ordering Information (See pages 49-50)**

©11/2024



# ICON Healthcare Alert Signage

## Information Icon Library

The standardized Information Icon library is easily augmented with any custom symbols and icons your care providers desire. Here is a sample of symbols currently found in the ICON library. We can design custom symbols to meet your facility's needs and brand. All icons can be designed to be multi-lingual.

### Icon Colors - Specify Icon number and color.\*

PMS referenced colors approximate actual colors.

Contact factory for samples.

Red PMS 200M

Orange PMS 021M

Yellow PMS 1235M

Green PMS 349M

Ocean Mist PMS 5425M

Naval Blue PMS 286M

Purple PMS 2607M

\*Text, custom colors and icons available. Please submit your requirements.



### Icon Index

1. Fall Risk
2. Nothing By Mouth
3. Immuno Compromise
4. Droplet Isolation
5. Not Allowed to Ambulate
6. Contact Isolation
7. Deceased
8. Pain Assessment
9. Patient at Test
10. Dizziness
11. Elopement
12. Latex Allergies
13. Physician Consult
14. Patient Code
15. Patient Code
16. Patient Code
17. Patient Code
18. Special Precautions
19. See Nurse
20. See Nurse Before Entering
21. Special Communications Needs
22. Seizure Precautions
23. Mother with Child
24. Calorie Count
25. I & O
26. Strict I & O
27. Hearing Impaired
28. Sight Impaired
29. No Venipuncture in Right Arm
30. No Venipuncture in Left Arm
31. Daily Weights
32. Fluid Restrictions
33. Swallowing Precautions
34. Quiet Please!
35. Caution Oxygen
36. Special Output Sampling
37. Neutropenic Precautions
38. Transplant Precautions
39. Transfusion Protocol
40. Allergy Precautions
41. Please Keep Door Closed
42. Wash Hands Before Entering
43. 24 Hour Specimen
44. Children Present
45. Plant Allergy Precaution
46. Food Allergy Precaution
47. Patient With Family
48. Patient With Pastor
49. Patient Eating
50. Aphasic
51. Aspiration Precautions
52. Bereavement
53. Pre-Term Infant
54. Do Not Resuscitate
55. Chair Alarm
56. Physician
57. Bloodwork
58. Consent
59. Injection
60. MRSA Infection
61. Labs Pending
62. Patient Demise
63. Biohazard
64. Chemotherapy
65. Aggression
66. Nurse to Remove Tray
67. Epidural
68. No Bottle
69. Shh, Quiet
70. Asphasia

All models include an Icon Index decal, mounted to the inside of the hinged panel for easy reference.



# ICON Healthcare Alert Signage

## Ordering Information and Specifications

**HOW TO SPECIFY ICON TABS**



Left: top to bottom & Right: top to bottom  
Icon number (see page 48) and color

#2 purple	#1 naval blue
#3 red	#5 ocean mist
#12 orange	#34 yellow
#4 green	#20 red

**Header Styles - C8, C10 and C12 Models only**  
Shown with optional EMB - Embossed Room Number and Braille

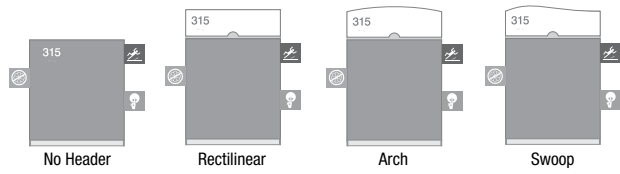

**Tab Configurations - C8, C10, C12 & DP Models**

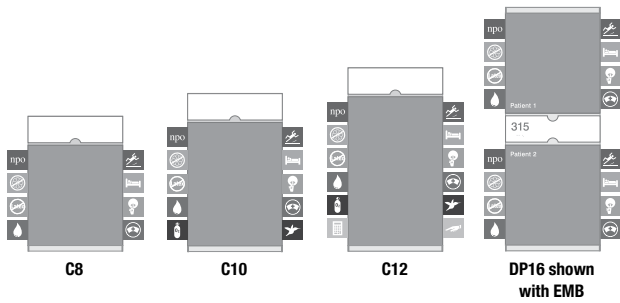

**Tab Configurations - Model C4S**



C4S shown with EMB

©11/2024



# ICON Healthcare Alert Signage

## Ordering Information and Specifications

### To Order Specify

1. Quantity
2. Model
3. Panel Color
4. Header Style (C8, C10 & C12 Models only)
5. Header Color
6. Icon Tab Number, Tab Color and Order (left top to bottom and right top to bottom)
7. Options

#### Header Styles (C8, C10 & C12 Models only)

No Header  
Rectilinear  
Arch  
Swoop

#### Header & Panel Finishes

Soft White  
Haze  
Seasand  
Wheat  
Khaki  
Lemongrass  
Ocean Mist  
Aluminum Metallic  
Taupe Metallic

See PPP Color Card or Web

#### Icon Tab Colors

Red  
Orange  
Yellow  
Green  
Ocean Mist  
Naval Blue  
Purple  
Custom Colors  
(Submit your requirements)

Icon Tab Numbers: *See page 48*

### Specifications

The ICON Healthcare Alert signs communicate critical patient information to the next doctor, nurse or clinician. Easily lock and unlock the colorful information tabs as needed, using the “push and slide” system concealed behind the hinged panel. Combine room identification and additional Infectious Disease Control inserts in a single system.

ICON is ADA (Accessibility Guidelines) compliant and may be customized to meet the requirements of your facility, department or unit.

- Construction: 24 ga. galvaneal steel hinged panel with magnetic latch. 1/2" depth. Hinged panel is magnetic and finished in acrylic polyurethane. Backer .063 aluminum.
- Header (C8, C10, C12 & DP Models only): Acrylic 2 1/2" h x 3/8" d. Dimensions on C8, C10 & C12 models include headers - subtract 2 1/2" for models without headers.
- **Optional Embossed Room Number/Letter**, Helvetica type 3/4" h, and Braille. Submit list of room numbers and specify placement on header and/or hinged panel when applicable.
- Icon Tabs: White icon on color tab, *specify color*. Digitally printed on durable .125" expanded PVC. Icon tabs are easily removed or changed.  
C & DP Models: 1 7/8" w x 1 7/8" h.
- Placard Inserts: With non-glare acrylic lens.
- Optional dry erase writing surface film for hinged panel — Upcharge.
- Mounting: Double-sided tape, standard; concealed pre-drilled holes for screw fasteners on request.
- Included: All models include an Icon Index decal, mounted to the inside of the hinged panel for easy reference.





PETER PEPPER PRODUCTS  
EXPRESSIVE ESSENTIALS®

**2025 PRICE  
LIST**

**PETER PEPPER PRODUCTS, INC.**  
**6525 Flotilla St**  
**Commerce CA 90040**

**T: 800 496 0204**

**W: [www.peterpepper.com](http://www.peterpepper.com)**

**E: [customerservice@peterpepper.com](mailto:customerservice@peterpepper.com)**